



# HF-Performer Intelligent for TL5 HE/HO lamps

## HF-Pi 2 28/35/49/54 TL5 EII 220-240V

HF-Performer Intelligent for Master and ECO TL5 HE/HO, TL-D and PL-L lamps HF-Performer Intelligent features automatic recognition of the connected lamp and is independently able to adjust its operation parameters exactly to the respective lamp. This results in a substantial benefit, especially for T5 lamps, as it means TL5 HE and HO lamps of the same length can be interchanged. With a choice of seven ballasts, the customer is able to handle efficiently every possible combination of Master TL5 and Eco, TL-D, and PL-L lamps.

### Product data

| General Information                          |              |
|--|--------------|
| Application Code                             | EII          |
| Type Version                                 | mk1          |
| Lamp Type                                    | TL5          |
| Number Of Lamps                              | 2 piece/unit |
| Number Of Products On MCB (16A Type B) (Nom) | 12           |
| Automatic Restart                            | Yes          |
| Operating and Electrical                     |              |
| Input Voltage                                | 220 to 240 V |
| Input Frequency                              | 50 to 60 Hz  |
| Ignition Method                              | Warm Start   |
| Crestfactor (Max)                            | 1.7          |
| Ignition Time (Max)                          | 5.0 s        |
| Mains Voltage Performance (AC)               | -8%+6%       |
| Mains Voltage Safety (AC)                    | -10%+10%     |

|                             |           |
|-----------------------------|-----------|
| Earth Leakage Current (Max) | 0.5 mA    |
| Inrush Current Width        | 0.35 ms   |
| Constant Wattage Deviation  | -2%/+2%   |
| Ballast Factor (Nom)        | 1.00      |
| Power Losses (Nom)          | 6.1-8.9 W |
| Inrush Current Peak (Max)   | 31 A      |

| Wiring                                   |                           |
|--|---------------------------|
| Connector Type Input Terminals           | Insert                    |
| Cable Capacity Output Wires Mutual (Nom) | 70 pF                     |
| Connector Type Output Terminals          | Insert                    |
| Cable Length Hot Wiring                  | 0.75 m                    |
| Wire Striplength                         | 8.0-9.0 mm                |
| Input Terminal Cross Section             | 0.50-1.00 mm <sup>2</sup> |
| Output Terminal Cross Section            | 0.50-1.00 mm <sup>2</sup> |

## HF-Performer Intelligent for TL5 HE/HO lamps

|  |                       |
|--|-----------------------|
| Cable Capacity Output Wires To Earth (Nom) | 70 pF                 |
| <b>System characteristics</b>              |                       |
| Rated Ballast-Lamp Power                   | 28-54 W               |
| Rated Lamp Power On TL5                    | 28/35/49/54 W         |
| System Power On TL5                        | 33.6/41.1/53/53.2 W   |
| Lamp Power On TL5                          | 27.5/34.4/45.6/48.4 W |
| Power Loss On TL5                          | 6.1/6.7/7.4/8 W       |
| <b>Temperature</b>                         |                       |
| T-Ambient (Max)                            | 50 °C                 |
| T-Ambient (Min)                            | -25 °C                |
| T-Storage (Max)                            | 80 °C                 |
| T-Storage (Min)                            | -40 °C                |
| T-Case Lifetime (Nom)                      | 75 °C                 |
| T-Case Maximum (Max)                       | 75 °C                 |
| T-Ignition (Max)                           | 50 °C                 |
| T-Ignition (Min)                           | -25 °C                |
| <b>Mechanical and Housing</b>              |                       |
| Housing                                    | L360x30x22            |
| <b>Emergency Operation</b>                 |                       |
| Battery Voltage Lamp Operation             | 198-276               |
| <b>Approval and Application</b>            |                       |
| Energy Efficiency Index                    | A2                    |
| EMI 9 kHz ... 30 MHz                       | EN55015               |

|                                    |   |
|------------------------------------|---|
| EMI 30 MHz ... 1000 MHz            | EN 55022 Class B                                |
| Safety Standard                    | IEC 61347-2-3                                   |
| Performance Standard               | IEC 60929                                       |
| Quality Standard                   | ISO 9000:2000                                   |
| Environmental Standard             | ISO 14001                                       |
| Harmonic Current Emission Standard | IEC 61000-3-2                                   |
| EMC Immunity Standard              | IEC 61547                                       |
| Vibration Standard                 | IEC68-2-6 F c                                   |
| Bumps Standard                     | IEC 68-2-29 Eb                                  |
| Humidity Standard                  | EN 61347-2-3 clause 11                          |
| Approval Marks                     | CE marking ENEC certificate VDE-EMV certificate |
| Temperature Marking                | Yes   |
| Emergency Standard                 | IEC 60598-2-22                                  |
| Hum And Noise Level                | Inaudible                                       |

### Product Data

|                                 |                                      |
|---------------------------------|--------------------------------------|
| Full product code               | 871150091502330                      |
| Order product name              | HF-Pi 2 28/35/49/54 TL5 EII 220-240V |
| EAN/UPC - Product               | 8711500915023                        |
| Order code                      | 913700624366                         |
| Numerator - Quantity Per Pack   | 1                                    |
| Numerator - Packs per outer box | 12                                   |
| Material Nr. (12NC)             | 913700624366                         |
| Net Weight (Piece)              | 0.305 kg                             |

### Dimensional drawing

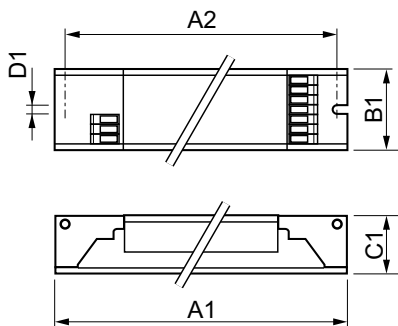

HF-Pi 2 28/35/49/54 TL5 EII 220-240V

| Product                              | D1     | C1    | A1     | A2     | B1    |
|--------------------------------------|--------|-------|--------|--------|-------|
| HF-Pi 2 28/35/49/54 TL5 EII 220-240V | 4.2 mm | 22 mm | 360 mm | 350 mm | 30 mm |

# HF-Performer Intelligent for TL5 HE/HO lamps

## Photometric data

| Ballast type                         | Lamp type  | Lamp power |                | T <sub>a</sub> = 40°C | T <sub>a</sub> = 50°C | T <sub>a</sub> = 60°C | Remarks                   |
|--------------------------------------|------------|------------|----------------|-----------------------|-----------------------|-----------------------|---------------------------|
| HF-Pi 2 28/35/49/54 TL5 EII 220-240V | TL5 HE     | 28W        |                |                       |                       |                       | T <sub>a</sub> max = 63°C |
|                                      | TL5 HE ECO | 25W        | T <sub>c</sub> | =54°C                 | =63°C                 | =72°C                 | 75°C                      |
|                                      | TL5 HE ECO | 32W        | Lifetime       | 100,000 Hrs           | 100,000 Hrs           | 100,000 Hrs           | 89,000 Hrs                |
|                                      | Lamp type  | Lamp power |                | T <sub>a</sub> = 40°C | T <sub>a</sub> = 50°C | T <sub>a</sub> = 60°C | Remarks                   |
|                                      | TL5 HE     | 35W        |                |                       |                       |                       | T <sub>a</sub> max = 54°C |
|                                      | TL5 HO     | 49W        |                |                       |                       |                       |                           |
|                                      | TL5 HO     | 54W        |                |                       |                       |                       |                           |
|                                      | TL5 HO ECO | 45W        | T <sub>c</sub> | =62°C                 | =71°C                 | x                     | 75°C                      |
|                                      | TL5 HO ECO | 50W        | Lifetime       | 100,000 Hrs           | 100,000 Hrs           | x                     | 57,000 Hrs                |
|                                      | TL-D       | 58W        |                |                       |                       |                       |                           |
|                                      | PL-L       | 55W        |                |                       |                       |                       |                           |
|                                      | TL5-C      | 60W        |                |                       |                       |                       |                           |

